

**Contact**

Post:

REPUBLIC OF SINGAPORE  
AERONAUTICAL  
INFORMATION SERVICES  
CIVIL AVIATION AUTHORITY  
OF SINGAPORE  
SINGAPORE CHANGI  
AIRPORT  
P.O. BOX 1, SINGAPORE  
918141

Tel: (65) 6422 7036

AFS: WSSSYNYX

Fax: (65) 64410221

Email: [caas\\_singaporeais@caas.gov.sg](mailto:caas_singaporeais@caas.gov.sg)URL: [www.caas.gov.sg](http://www.caas.gov.sg)URL: <https://aim-sg.caas.gov.sg>**AIP Supplement for  
Singapore****AIRAC AIP SUP****059/2021****Effective from 20 MAY 2021****PERM****Published on 08 APR 2021**

## SINGAPORE CHANGI AIRPORT - RE-DESIGNATION OF TAXIWAYS AND TAXILANES (PHASE 4 – FINAL PHASE)

**1 INTRODUCTION**

1.1 Singapore Changi Airport will be carrying out works to re-designate the taxiways and taxilanes over a few phases to optimise the taxiways and taxilanes designation to facilitate future airport expansion.

1.2 The new taxiway and taxilane designations for this Phase 4 (Final Phase) of works will be effective on **20 May 2021, 1945UTC**.

**2 NEW TAXIWAY AND TAXILANE DESIGNATIONS**

2.1 The new taxiway and taxilane designations for the affected taxiways and taxilanes are shown below and in **Chart 1**.

Current TWY / TXL designations	New TWY / TXL designations
C1	R4
C3	R5
C2	R6
C6	R7
C7	R8
SC1	R
SC2	S
EP	T
EN	T1
E1	T2
E2	T3
E3	T4
E4	T5
E5	T6
E6	T7
E7	T8
E8	T9
E9	T10
E10	T11
E11	T12
L4	U1
L5	U2
L6	U3
L10	U4
L7	U7
L8	U8

Current TWY / TXL designations	New TWY / TXL designations
L9	U9

### 3 WORK ZONES AND SCHEDULED CLOSURES OF AFFECTED TAXIWAYS AND TAXILANES

3.1 In order to facilitate the re-designation of taxiways and taxilanes, taxiway closures will be carried out during the night between 1600UTC and 2200UTC on 20 May 2021.

3.2 Details of the work zones and corresponding closure of affected taxiways and taxilanes are tabulated below and shown in **Chart 2 and Chart 3**.

Work zone	Closure of affected taxiways and taxilanes	Closure time
Zone 1	TWY EP between TXL R3 and TWY L8, including junction of TWY EP and TWY L8	From 1600UTC to 2000UTC
	TWY C1	
	TXL C2	
	TWY C3	
	TXL C6	
	TWY C6	
	TWY C7	
	TXL L4	
	TXL L5	
	TWY L6	
	TWY L7	
	TWY L8	
	Junction of TWY L9 and TXL L5	
	TWY L10	
	TWY SC1	
	TWY SC2	
	TWY S1	
	TWY S2 between TXL S4 and TWY S1, including junction of TWY S2 and TWY S1	
	TWY S3 between TXL S4 and TWY S1, including junction of TWY S3 and TWY S1	
	TWY W between TWY W9 and TWY W10, including junction of TWY W and TWY W9, and junction of TWY W and TWY W10	
TWY W9 ( <b>*Exit Taxiway for Runway 20R</b> )		
TWY W10 ( <b>*Exit Taxiway for Runway 20R</b> )		
TWY V from TWY S1 until behind Aircraft Stand A15, including junction of TWY V and TWY S1		
TWY V9 between TWY W and TWY V10, including junction of TWY V9 and TWY V10		
TWY V10		
TXL V11		
Zone 2a	TWY K between TWY P1 and TWY K1, including junction of TWY K, TWY P1 and TXL N5	From 1600UTC to 1830UTC
	TXL N5 from TWY P1 until before Aircraft Stand 611	
	TWY P1 between TWY N and TXL N5	
Zone 2b	TWY J between TWY EP and TWY K1, including junction of TWY J and TWY EP	From 1600UTC to 2030UTC
	TWY EP between TWY J and TWY K	

Work zone	Closure of affected taxiways and taxilanes	Closure time
Zone 3	TWY P1 between TWY P4 and TWY K, including junction of TWY P1 and TWY P4	From 1930UTC to 2200UTC
	TWY EP between TWY P and TWY C1, including junction of TWY EP and TWY P	
	TWY N between TXL N4 and TWY P1	
	TWY P between TWY P1 and TWY EP, including junction of TWY P and TWY P1	
	TWY Q between TWY P1 and TWY EP, including junction of TWY Q and TWY P1	
	TWY P2 between TWY P1 and TWY EP, including junction of TWY P2 and TWY P1	
	TWY P3	
	TWY P4 between TXL P7 and TWY EP	
	Junction of TWY P5 and TWY EP	
	TXL R1	
	TXL R2	
	TXL R3	

3.3 Delays to aircraft movements may occur during the works and immediately after the new taxiways / taxilanes designation are effective. Follow-me vehicles may be deployed during the period of works to facilitate unforeseen towing requests, if operationally necessary.

3.4 The updated taxiways and taxilanes designation are shown in **Chart 4, Chart 5, Chart 6 and Chart 7**.

**4 IMPACT TO ARRIVALS ON RUNWAY 20R**

4.1 During Zone 1 taxiways closure from 1600UTC to 2000UTC, aircraft landing on Runway 20R must vacate the runway via TWY W6, W7 or W8 due to closure of TWY W9 and W10. Aircraft that is unable to vacate Runway 20R via TWY W8 shall stop immediately and contact ATC for further instructions.

**5 CANCELLATION**

5.1 **This AIRAC AIP Supplement supersedes AIRAC AIP Supplement 047/2021 dated 11 March.**

5.2 Any change to the contents of this AIP Supplement will be notified through NOTAM.

5.3 This AIP Supplement will remain current until the information is incorporated into AIP Singapore.

New taxiway and taxilane designations ..... [Chart 1](#)  
 Taxiways and taxilanes closure – work zone 1 ..... [Chart 2](#)  
 Taxiways and taxilanes closure – work zones 2a, 2b and 3 ..... [Chart 3](#)  
 Updated taxiway and taxilane designations ..... [Chart 4](#)  
 Updated taxiway and taxilane designations (Enlarged – Part 1) ..... [Chart 5](#)  
 Updated taxiway and taxilane designations (Enlarged – Part 2) ..... [Chart 6](#)  
 Updated taxiway and taxilane designations (Enlarged – Part 3) ..... [Chart 7](#)

*PAGE INTENTIONALLY LEFT BLANK*

# NEW TAXIWAY AND TAXILANE DESIGNATIONS

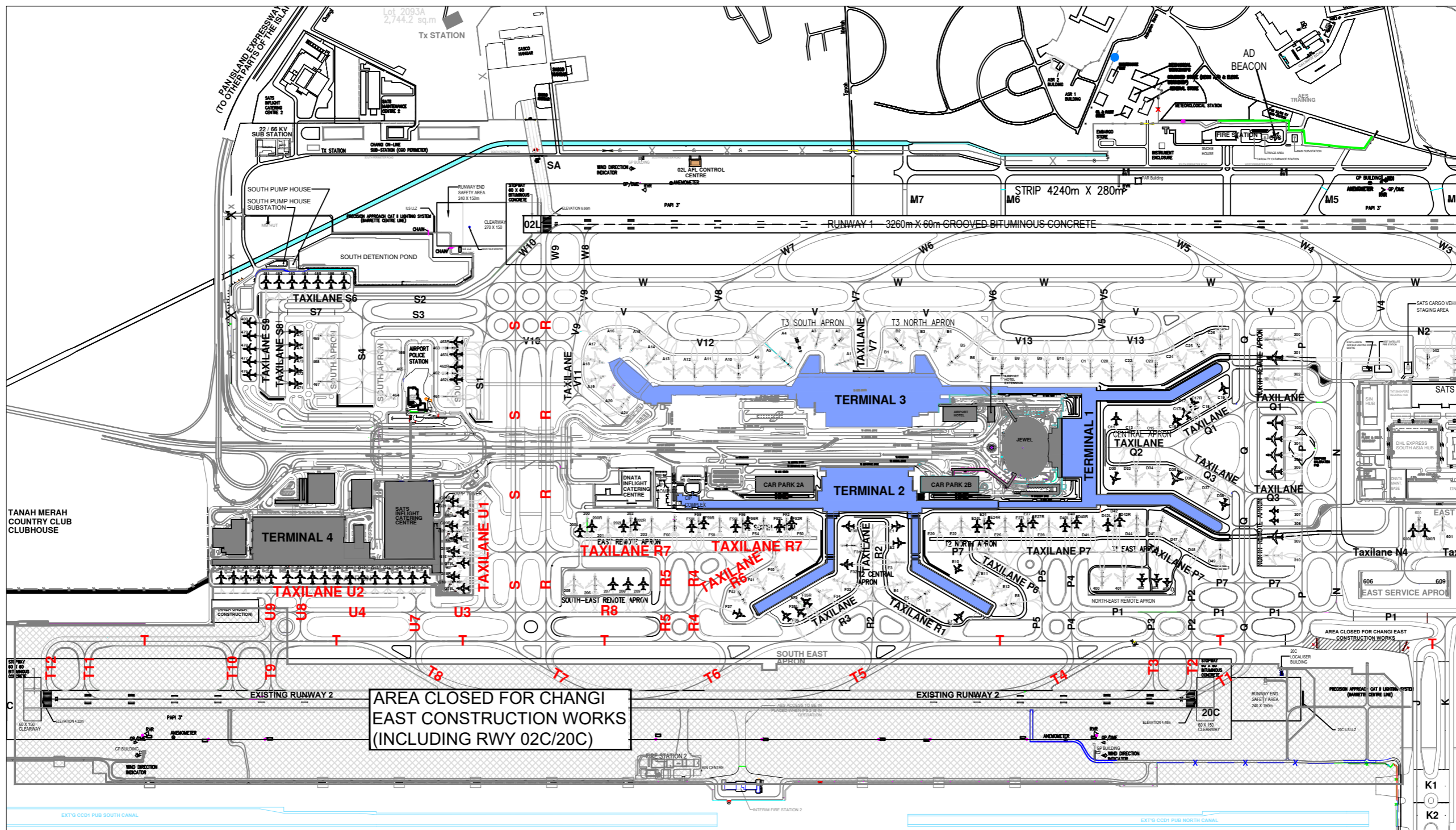

*PAGE INTENTIONALLY LEFT BLANK*

# TAXIWAYS AND TAXILANES CLOSURE - WORK ZONE 1

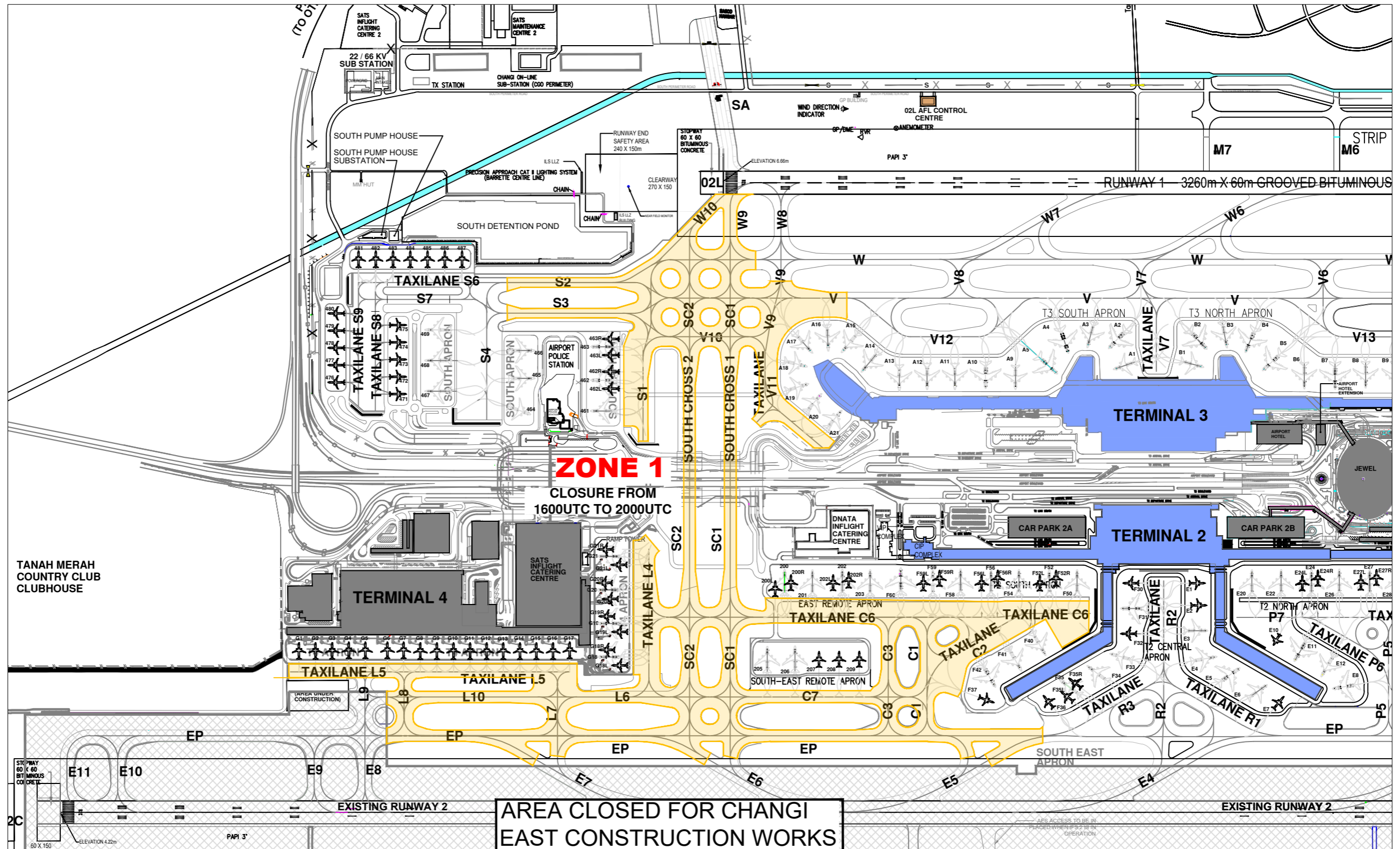

**LEGEND**

ZONE	COLOUR CODE	CLOSURE TIME
ZONE 1	<span style="background-color: yellow; border: 1px solid black; display: inline-block; width: 20px; height: 10px;"></span>	1600UTC TO 2000UTC

TANAH MERAH COUNTRY CLUB CLUBHOUSE

AREA CLOSED FOR CHANGI EAST CONSTRUCTION WORKS

*PAGE INTENTIONALLY LEFT BLANK*



# TAXIWAYS AND TAXILANES CLOSURE

## WORK ZONE 3

## WORK ZONE 2a AND 2b

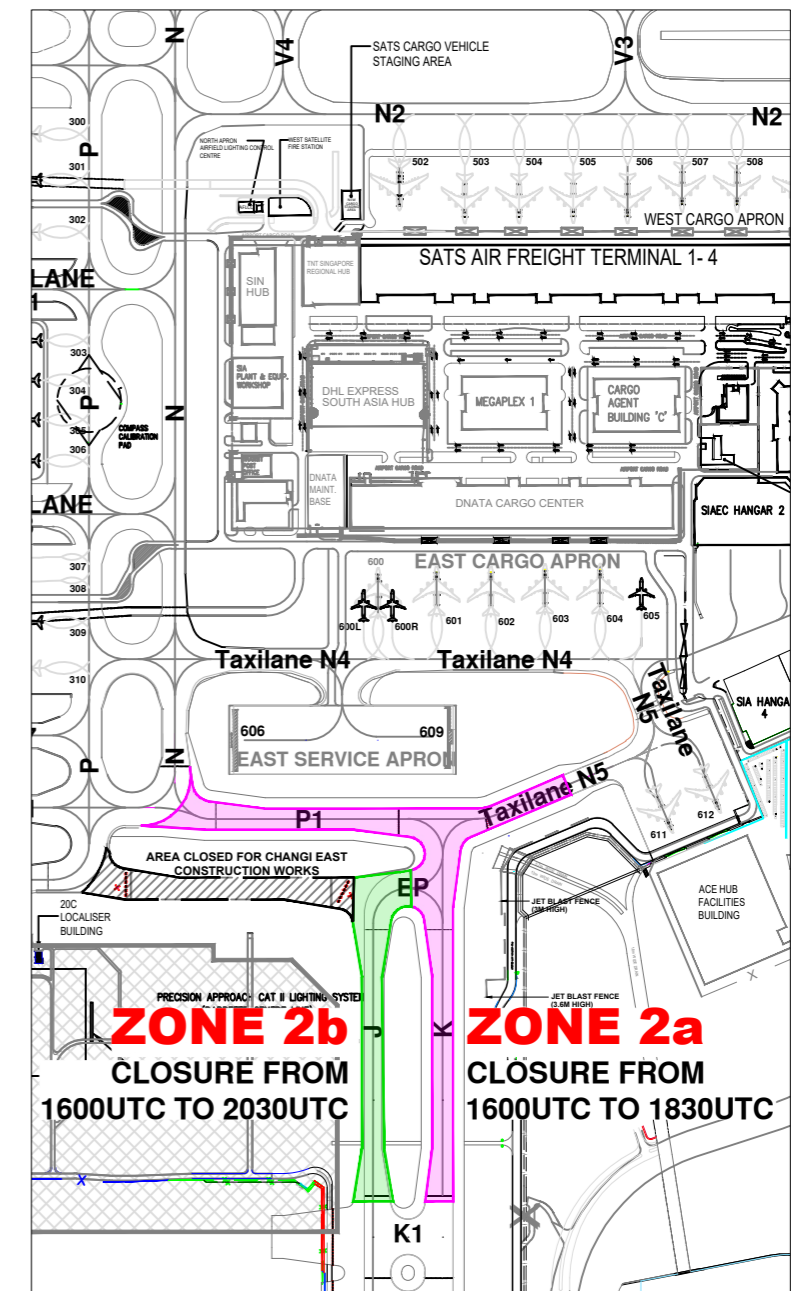
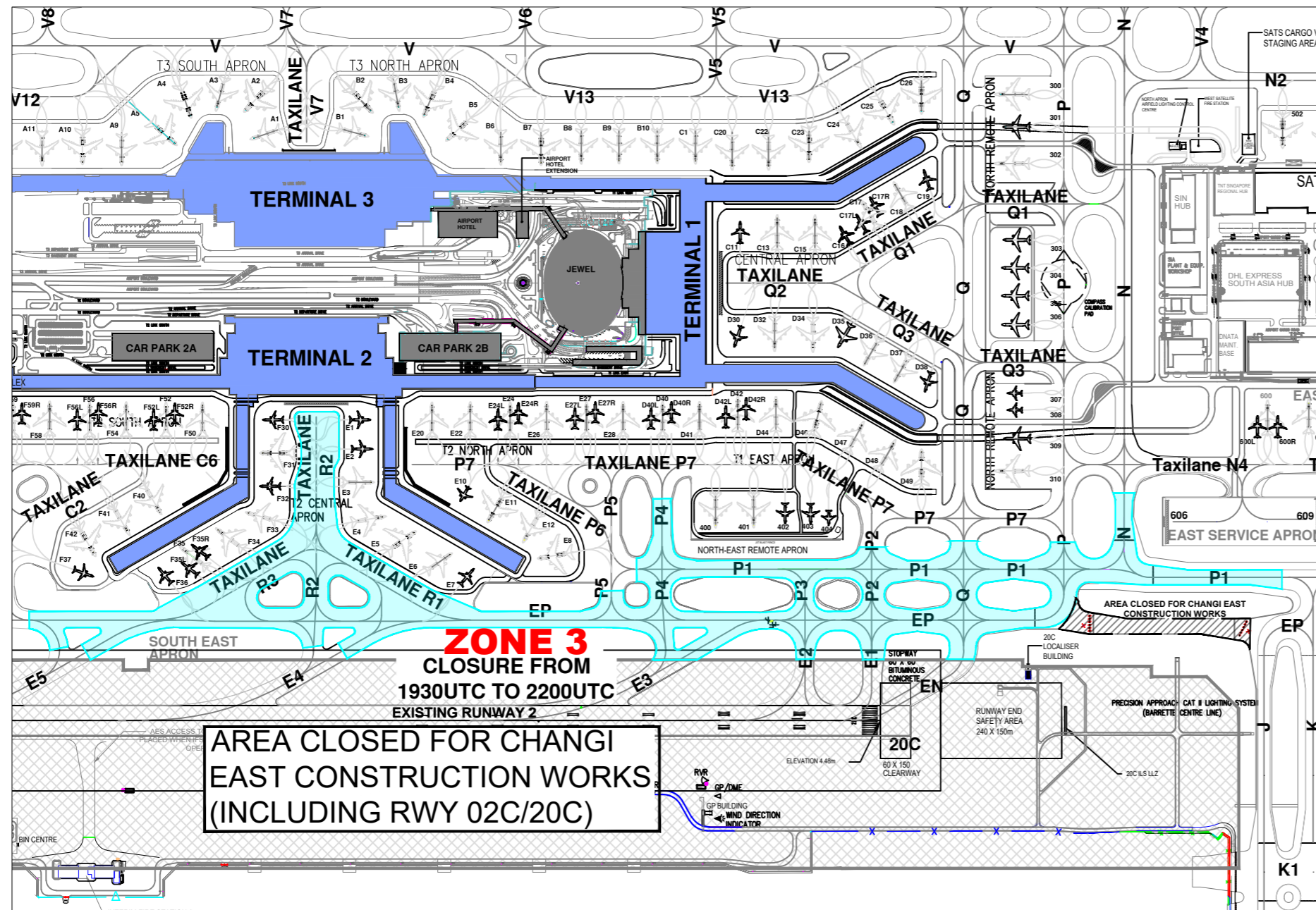

**LEGEND**

ZONE	COLOUR CODE	CLOSURE TIME
ZONE 3	<span style="background-color: cyan; border: 1px solid black; display: inline-block; width: 20px; height: 10px;"></span>	1930UTC TO 2200UTC

**LEGEND**

ZONE	COLOUR CODE	CLOSURE TIME
ZONE 2a	<span style="background-color: pink; border: 1px solid black; display: inline-block; width: 20px; height: 10px;"></span>	1600UTC TO 1830UTC
ZONE 2b	<span style="background-color: green; border: 1px solid black; display: inline-block; width: 20px; height: 10px;"></span>	1600UTC TO 2030UTC

*PAGE INTENTIONALLY LEFT BLANK*

# UPDATED TAXIWAY AND TAXILANE DESIGNATIONS EFFECTIVE FROM 1945UTC ON 20 MAY 2021

AIP Singapore

AERODROME CHART - ICAO

01° 21' 33"N  
103° 59' 22"E

AERODROME ELEVATION 6.66m

TWR 118.6 / 118.25  
GND 124.3 / 121.85 / 121.725  
DELIVERY 121.65

RAMP TWR 122.55 (GMC 4 EAST)  
GND 125.65 (GMC 4 WEST)

SINGAPORE/SINGAPORE CHANGI

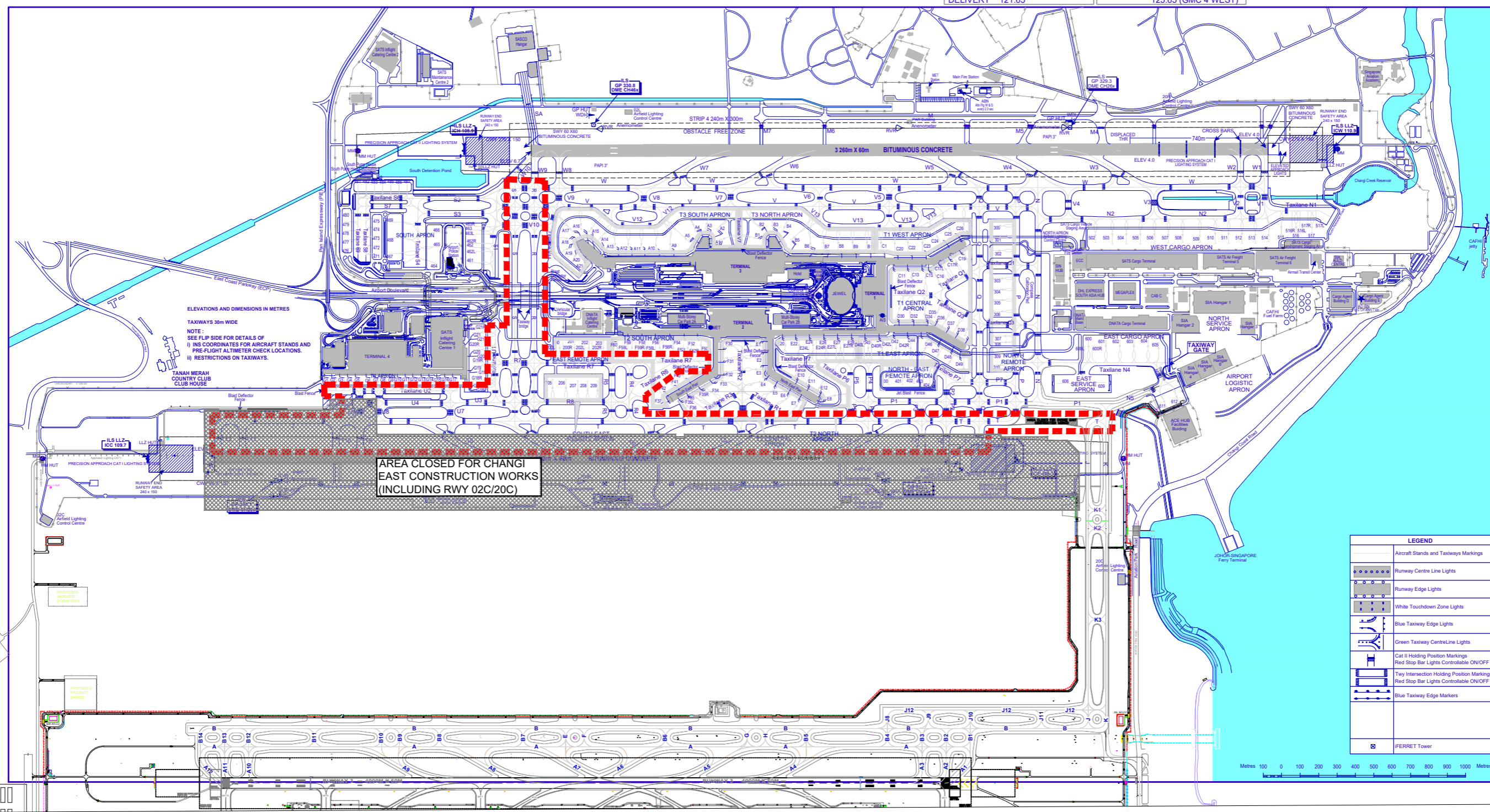

ELEVATIONS AND DIMENSIONS IN METRES  
TAXIWAYS 30m WIDE  
NOTE:  
I) ICS COORDINATES FOR AIRCRAFT STANDS AND PRE-FLIGHT ALTIMETER CHECK LOCATIONS.  
II) RESTRICTIONS ON TAXIWAYS.

AREA CLOSED FOR CHANGI EAST CONSTRUCTION WORKS (INCLUDING RWY 02C/20C)

LEGEND	
	Aircraft Stands and Taxiways Markings
	Runway Centre Line Lights
	Runway Edge Lights
	White Touchdown Zone Lights
	Blue Taxiway Edge Lights
	Green Taxiway Centre Line Lights
	Cat II Holding Position Markings
	Red Stop Bar Lights Controllable ON/OFF
	Taxiway Intersection Holding Position Markings
	Red Stop Bar Lights Controllable ON/OFF
	Blue Taxiway Edge Markers
	FERRET Tower

Metres 100 0 100 200 300 400 500 600 700 800 900 1000 Metres

*PAGE INTENTIONALLY LEFT BLANK*

# UPDATED TAXIWAY AND TAXILANE DESIGNATIONS (ENLARGED -PART 1) EFFECTIVE FROM 1945UTC ON 20 MAY 2021

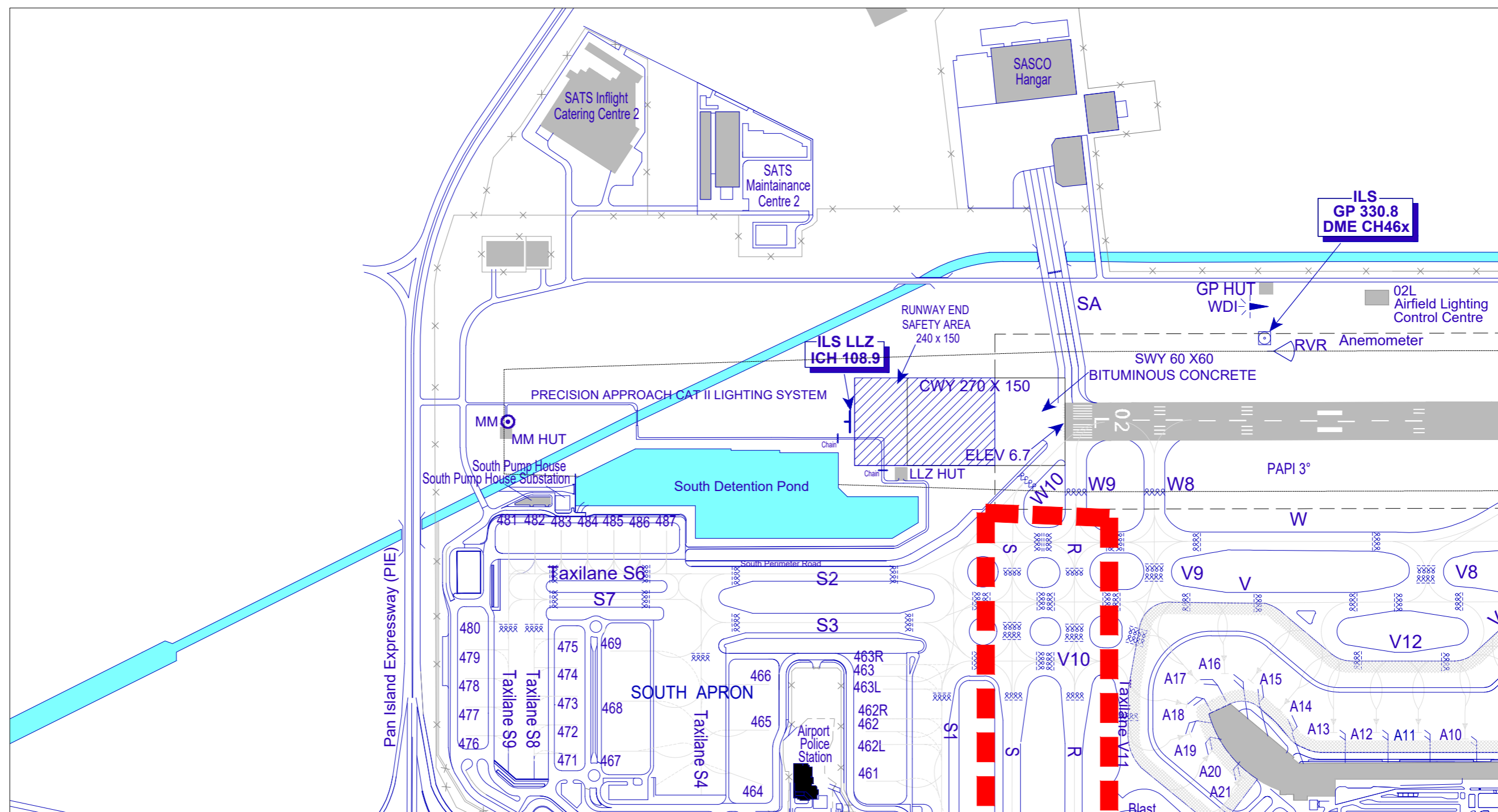

*PAGE INTENTIONALLY LEFT BLANK*

# UPDATED TAXIWAY AND TAXILANE DESIGNATIONS (ENLARGED -PART 2) EFFECTIVE FROM 1945UTC ON 20 MAY 2021

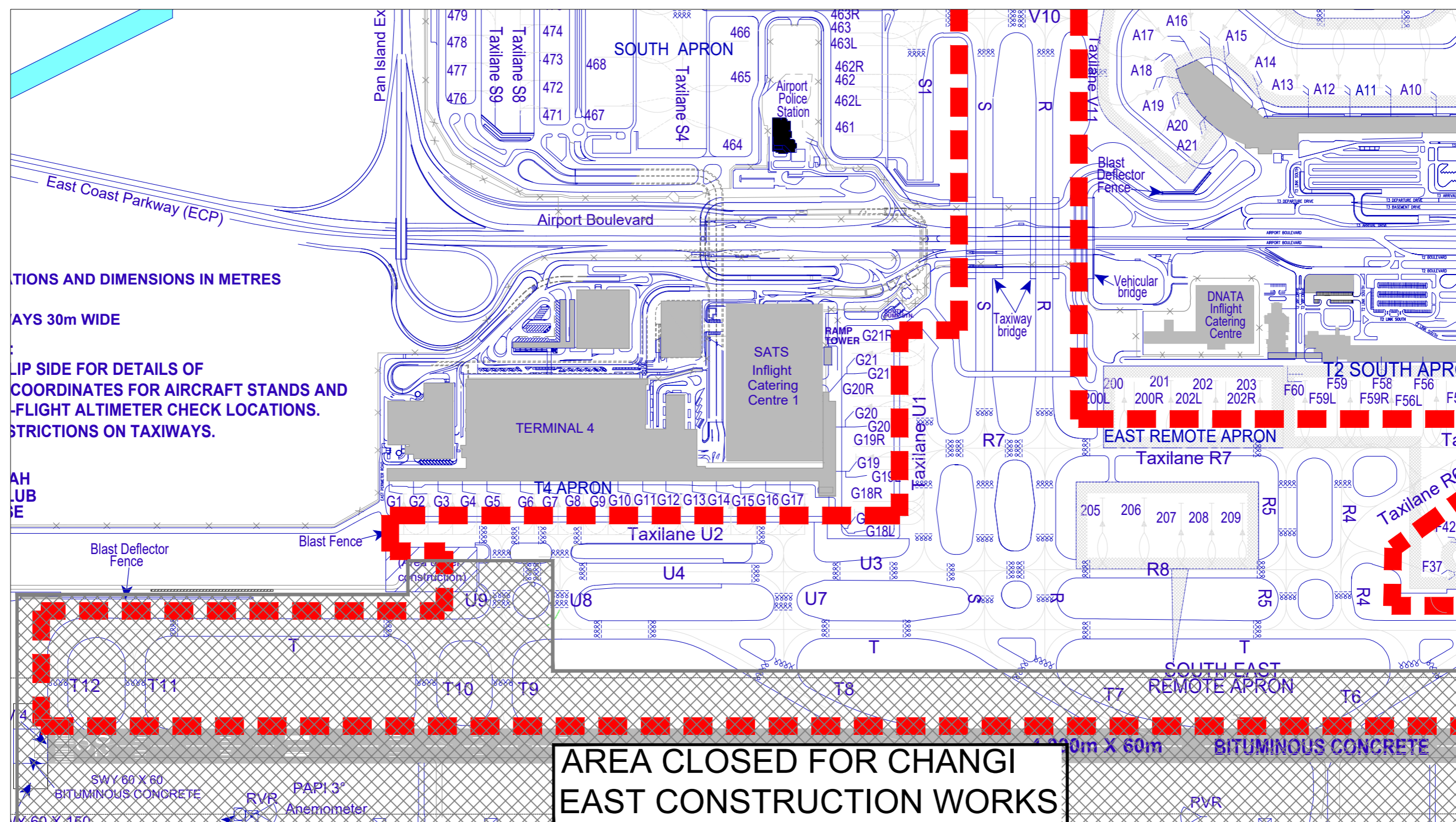

*PAGE INTENTIONALLY LEFT BLANK*



# UPDATED TAXIWAY AND TAXILANE DESIGNATIONS (ENLARGED -PART 3) EFFECTIVE FROM 1945UTC ON 20 MAY 2021

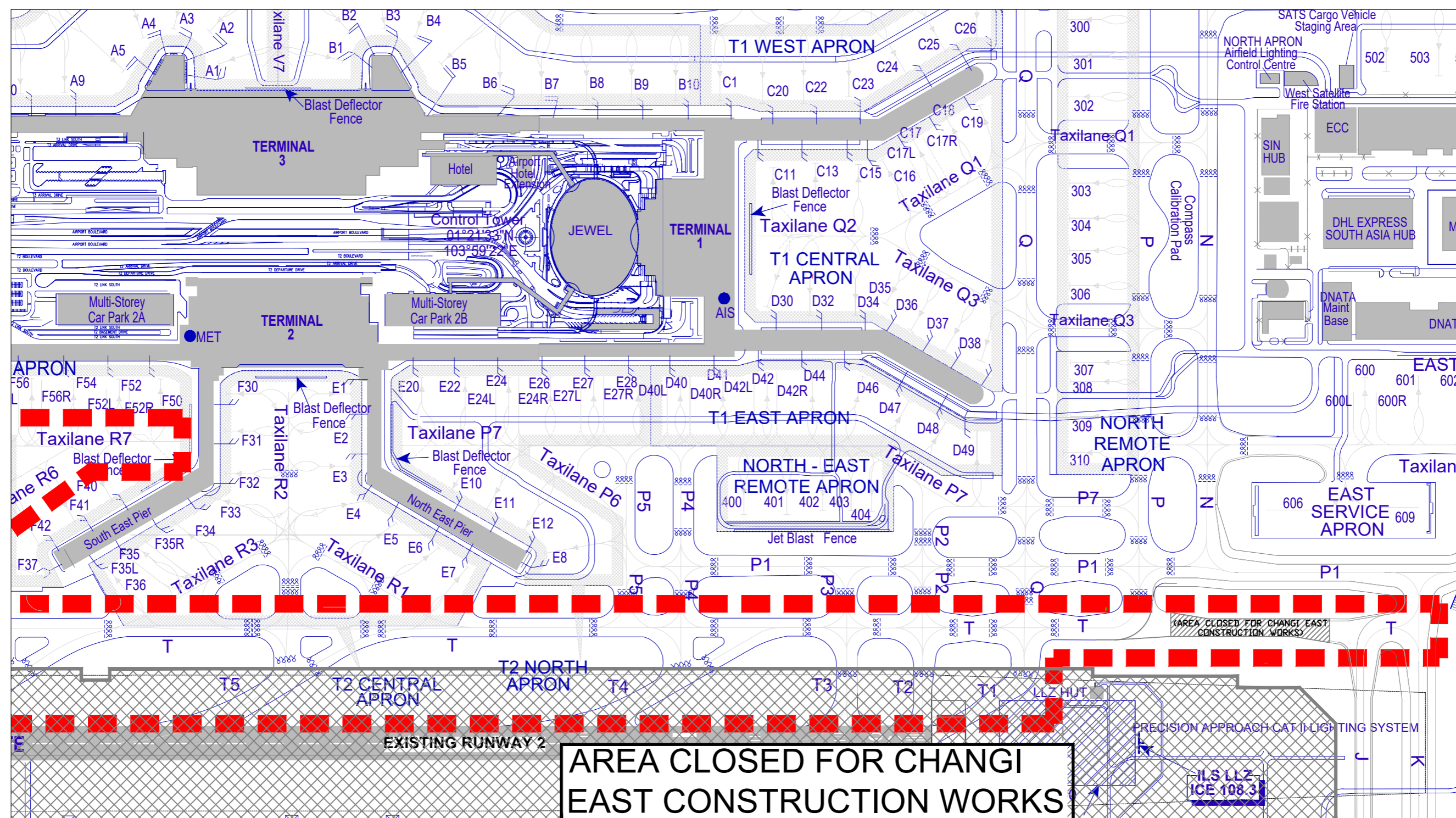

*PAGE INTENTIONALLY LEFT BLANK*