

Telephone: (65) 6595 6051
AFS: WSSSYNYX
Facsimile: (65) 6441 0221
caas_singaporeais@caas.gov.sg
www.caas.gov.sg

REPUBLIC OF SINGAPORE
AERONAUTICAL INFORMATION SERVICES
CIVIL AVIATION AUTHORITY OF SINGAPORE
SINGAPORE CHANGI AIRPORT
P.O. BOX 1, SINGAPORE 918141

AIP SUPPLEMENT

26/15
9TH JANUARY

WORKS SCHEDULE AND MOVEMENT AREA RESTRICTIONS PERTAINING TO THE DIVERSION OF AIRSIDE SERVICES AND SOIL IMPROVEMENT WORKS AT SINGAPORE CHANGI AIRPORT

1. INTRODUCTION

- 1.1. Singapore Changi Airport is currently undergoing an upgrading programme to divert the airside services infrastructure; including relocating existing utilities and carrying out soil improvement works.

2. PURPOSE

- 2.1. The purpose of this AIP Supplement is to notify the aviation industry of the upgrading programme works schedule and movement areas restrictions at Singapore Changi Airport from 12 February 2015 to 24 October 2015.

3. CONSTRUCTION ZONES AND WORKS SCHEDULE FOR AIRSIDE SERVICES DIVERSION

- 3.1. The construction works for the airside services diversion is divided into three zones. Please refer to **Appendix A** for the location of the construction works zones.
- 3.2. The sectors, locations and duration of the construction works are shown in the following table:

Location	Duration (All timings in UTC)
Zone S1	2300/1100 daily from 12/13 Feb 15 to 29/30 Sep 15.
Zone S2	2300/1100 daily from 12/13 Feb 15 to 27/28 Feb 15. From 1700UTC 1 Mar 15 to 2230UTC 30 Sep 15, please refer to paragraph 5.1 for Runway 02C/20C closures.
Zone S3	Commence after 30 Sep 15. Actual date and time will be notified by NOTAM.
Zone S4	2300/1100 daily from 31 Jul/1 Aug 15 to 29/30 Sep 15.
Zone S5	2300/1100 daily from 31 Jul/1 Aug 15 to 29/30 Sep 15.

4. CONSTRUCTION ZONES AND WORKS SCHEDULE FOR SOIL IMPROVEMENT

4.1. The construction works for soil improvement is divided into three phases. Please refer to **Appendix B** for the location of the construction works.

Phase	Location	Duration
Phase J1	Location A	Commence after 30 Sep 15. Actual date and time will be notified by NOTAM.
	Locations A1 and B	Commence after 30 Sep 15. Actual date and time will be notified by NOTAM.
Phase J2	Location C	Commence after 30 Sep 15. Actual date and time will be notified by NOTAM.
Phase J3	Location D	1700UTC 1 Mar 15 to 2230UTC 30 Sep 15. (Runway 02C/20C will be closed. Please refer to paragraph 5.1)

5. CLOSURE OF RUNWAY 02C/20C and RUNWAY 02L/20R

5.1 Runway 02C/20C and Runway 02L/20R will be closed for works and maintenance as follows:

Time in UTC	Runway 02L/20R	Runway 02C/20C
1700/2300	6 Mar, 16 Mar, 18 Mar, 3 Apr, 20 Apr, 22 Apr, 1 May, 18 May, 20 May, 5 Jun, 15 Jun, 17 Jun, 3 Jul, 20 Jul, 22 Jul, 31 Jul, 17 Aug, 19 Aug, 4 Sep, 14 Sep, 16 Sep, 2 Oct, 19 Oct and 21 Oct.	13 Mar, 23 Mar, 25 Mar, 10 Apr, 27 Apr, 29 Apr, 8 May, 25 May, 27 May, 12 Jun, 22 Jun, 24 Jun, 10 Jul, 27 Jul, 29 Jul, 7 Aug, 24 Aug, 26 Aug, 11 Sep, 21 Sep, 25 Sep and 9 Oct.
1700/2230	3 Mar, 10 Mar, 14 Mar, 24 Mar, 28 Mar, 31 Mar, 7 Apr, 11 Apr, 14 Apr, 28 Apr, 5 May, 9 May, 12 May, 26 May, 30 May, 2 Jun, 9 Jun, 13 Jun, 23 Jun, 27 Jun, 30 Jun, 7 Jul, 11 Jul, 14 Jul, 28 Jul, 4 Aug, 8 Aug, 11 Aug, 25 Aug, 29 Aug, 1 Sep, 8 Sep, 12 Sep, 22 Sep, 26 Sep, 29 Sep, 6 Oct, 10 Oct, 13 Oct and 17 Oct.	1-2 Mar, 4-5 Mar, 7-9 Mar, 11-12 Mar, 15 Mar, 17 Mar, 19-22 Mar, 26-27 Mar, 29-30 Mar, 1-6 Apr, 8-9 Apr, 12-13 Apr, 15-19 Apr, 21 Apr, 23-26 Apr, 30 Apr, 2-4 May, 6-7 May, 10-11 May, 13-17 May, 19 May, 21-24 May, 28-29 May, 31 May, 1 Jun, 3-4 Jun, 6-8 Jun, 10-11 Jun, 14 Jun, 16 Jun, 18-21 Jun, 25-26 Jun, 28-29 Jun, 1-2 Jul, 4-6 Jul, 8-9 Jul, 12-13 Jul, 15-19 Jul, 21 Jul, 23-26 Jul, 30 Jul, 1-3 Aug, 5-6 Aug, 9-10 Aug, 12-16 Aug, 18 Aug, 20-23 Aug, 27-28 Aug, 30-31 Aug, 2-3 Sep, 5-7 Sep, 9-10 Sep, 13 Sep, 15 Sep, 17-20 Sep, 23-24 Sep, 27-28 Sep, 30 Sep, 1 Oct, 3-5 Oct, 7-8 Oct, 11-12 Oct, 14-16 Oct, 18 Oct, 20 Oct and 22-24 Oct.

6. MARKING AND LIGHTING

- 6.1. All unserviceable areas on taxiways or aprons will be demarcated by marker boards. The marker boards will be painted in alternate bands of red and white, and will be lighted at night and during limited visibility conditions by omni-directional fixed red lights.
- 6.2. All unserviceable areas 107m from Runway 02C/20C centreline will be demarcated by marker boards placed parallel to Runway 02C/20C (refer to Appendix A). The marker boards will be painted in alternate bands of red and white, and will be lighted at night and during low visibility conditions by omni-directional fixed red lights.

7. PRECAUTIONS

- 7.1. During the construction period, pilots are to take note of the following at the work areas as shown in **Appendices A and B**:
 - a) Presence of construction equipment beyond 107m from Runway 02C/20C centreline and on the northern and southern ends of Runway 02C/20C threshold.
 - b) All construction equipment will be kept clear of the obstacle free zone when Runway 02C/20C is operational.
 - c) Emergency response and evacuation plan (for removal of machinery and manpower) will be in place in case of any airport emergency.

8. CHANGES

- 8.1. Any changes to the contents of this AIP Supplement will be notified through NOTAM.

Airside Service Diversion Construction Zones

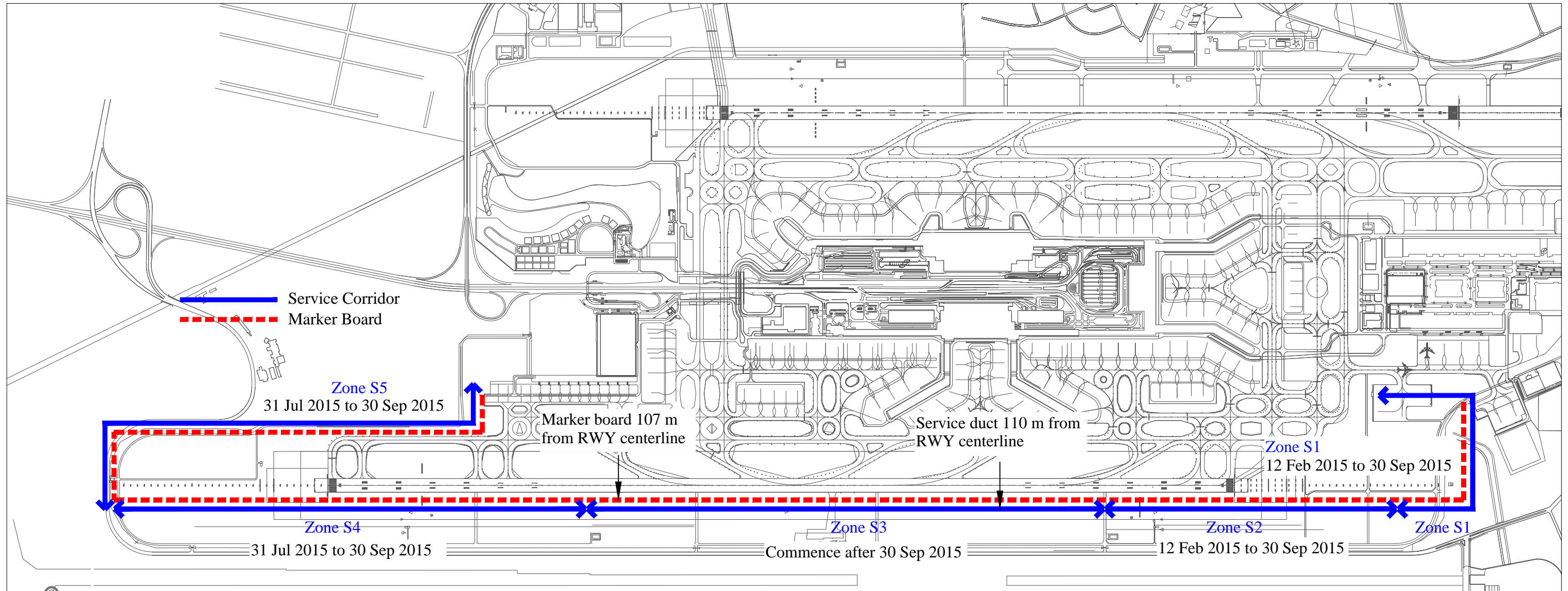

Service Corridor
Marker Board

Zone S5
31 Jul 2015 to 30 Sep 2015

Marker board 107 m
from RWY centerline

Service duct 110 m from
RWY centerline

Zone S1
12 Feb 2015 to 30 Sep 2015

Zone S4
31 Jul 2015 to 30 Sep 2015

Zone S3
Commence after 30 Sep 2015

Zone S2
12 Feb 2015 to 30 Sep 2015

Zone S1

Soil Improvement Work Construction Phases and Locations

