

**Contact**

Post:

REPUBLIC OF SINGAPORE  
AERONAUTICAL  
INFORMATION SERVICES  
CIVIL AVIATION AUTHORITY  
OF SINGAPORE  
SINGAPORE CHANGI  
AIRPORT  
P.O. BOX 1, SINGAPORE  
918141

Tel: (65) 6595 6051

AFS: WSSSYNYX

Fax: (65) 64410221

Email: [caas\\_singaporeais@caas.gov.sg](mailto:caas_singaporeais@caas.gov.sg)URL: [www.caas.gov.sg](http://www.caas.gov.sg)URL: <https://fpl-1.caasaim.gov.sg>

## AIP Supplement for Singapore

**AIP SUP****090/2016****Effective from 21 NOV 2016****UFN****Published on 15 NOV 2016**

# SINGAPORE CHANGI AIRPORT - CHANGES TO AIRCRAFT STAND F35 DETAILS AND OPENING OF NEW MULTIPLE AIRCRAFT RECEIVING STANDS (MARS) F35L AND F35R AT TERMINAL 2

**1 INTRODUCTION**

1.1. This AIP Supplement is to inform airline operators and pilots of changes to aircraft stand F35 details and opening of new MARS F35L and F35R to support the operations at Terminal 2 in Singapore Changi Airport with effect from 21 November 2016 0900UTC.

1.2. This AIP Supplement also describes the pushback procedures for aircraft departing from existing aircraft stand F35 and new MARS F35L and F35R.

**2 DETAILS OF AIRCRAFT STANDS F35, F35L AND F35R**

2.1 Aircraft stands F35, F35L and F35R will be used for active / tow operations. Details are as follows:

Number	Aircraft stand		Aircraft types that can be parked at the aircraft stand
	Location (WGS-84 coordinates)	Elevation	
F35	N01° 21' 06.60" E103° 59' 29.55"	4.91m (16.11ft)	A359, B762, B763, B788 and B789
F35L	N01° 21' 06.06" E103° 59' 30.13"	4.74m (15.55ft)	A319, A320, A321 and B737
F35R	N01° 21' 06.96" E103° 59' 29.05"	5.04m (16.54ft)	A319, A320, A321 and B737

2.2 Please see Appendices 1A and 1B for the location of aircraft stands F35, F35L and F35R.

**3 PUSHBACK PROCEDURES FOR DEPARTING AIRCRAFT**

3.1 The pushback procedures for aircraft departing from aircraft stands F35, F35L and F35R are as follows:

Aircraft stand	Pushback Procedure	Phraseology used by Singapore Ground
F35	The aircraft (on idle thrust) shall be pushed back onto Taxilane B3 to face south until its nosewheel is at the intersection of the aircraft stand lead-in line and Taxilane B3 centreline.  The aircraft may breakaway from there.	Standard pushback approved
F35L	The aircraft (on idle thrust) shall be pushed back following the pushback line onto Taxilane B3 to face south until the nose of the aircraft is behind the stopbar behind aircraft stand F35.  The aircraft may breakaway from there.	Standard pushback approved

Aircraft stand	Pushback Procedure	Phraseology used by Singapore Ground
F35R	The aircraft (on idle thrust) shall be pushed back following the pushback line onto Taxilane B3 to face south until its nosewheel is at the intersection of the aircraft stand pushback line and Taxilane B3 centreline.  The aircraft may breakaway from there.	Standard pushback approved

#### 4 CONCLUSION

4.1 Any change to the contents of this AIP Supplement will be notified through NOTAM.

# LOCATION OF AIRCRAFT STANDS F35, F35L AND F35R AT TERMINAL 2, SINGAPORE CHANGI AIRPORT WITH EFFECT FROM 21 NOVEMBER 2016, 0900 UTC

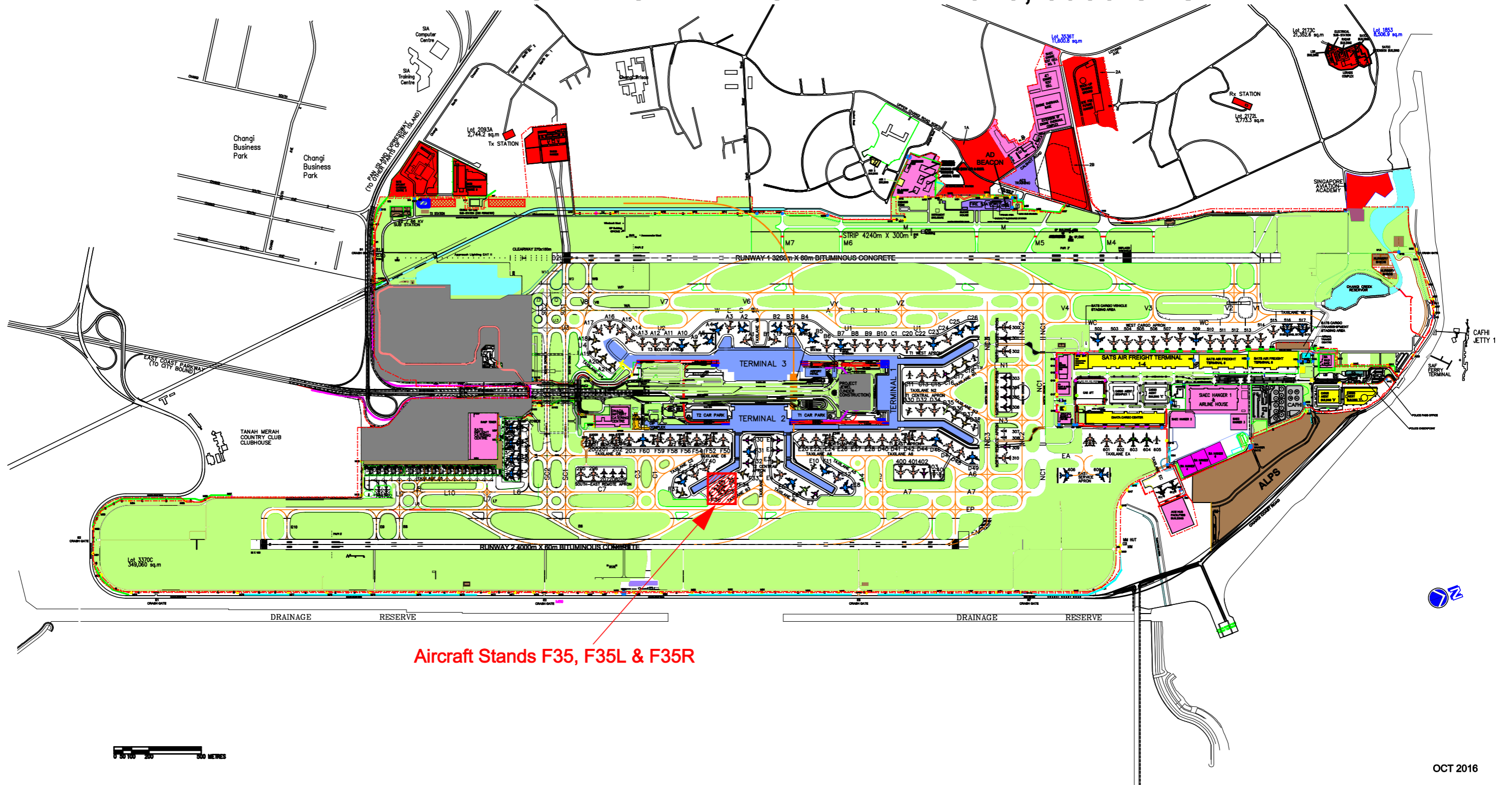

Aircraft Stands F35, F35L & F35R

*PAGE INTENTIONALLY LEFT BLANK*

# ENLARGED LOCATION PLAN OF AIRCRAFT STANDS F35, F35L AND F35R AT TERMINAL 2, SINGAPORE CHANGI AIRPORT WITH EFFECT FROM 21 NOVEMBER 2016, 0900 UTC

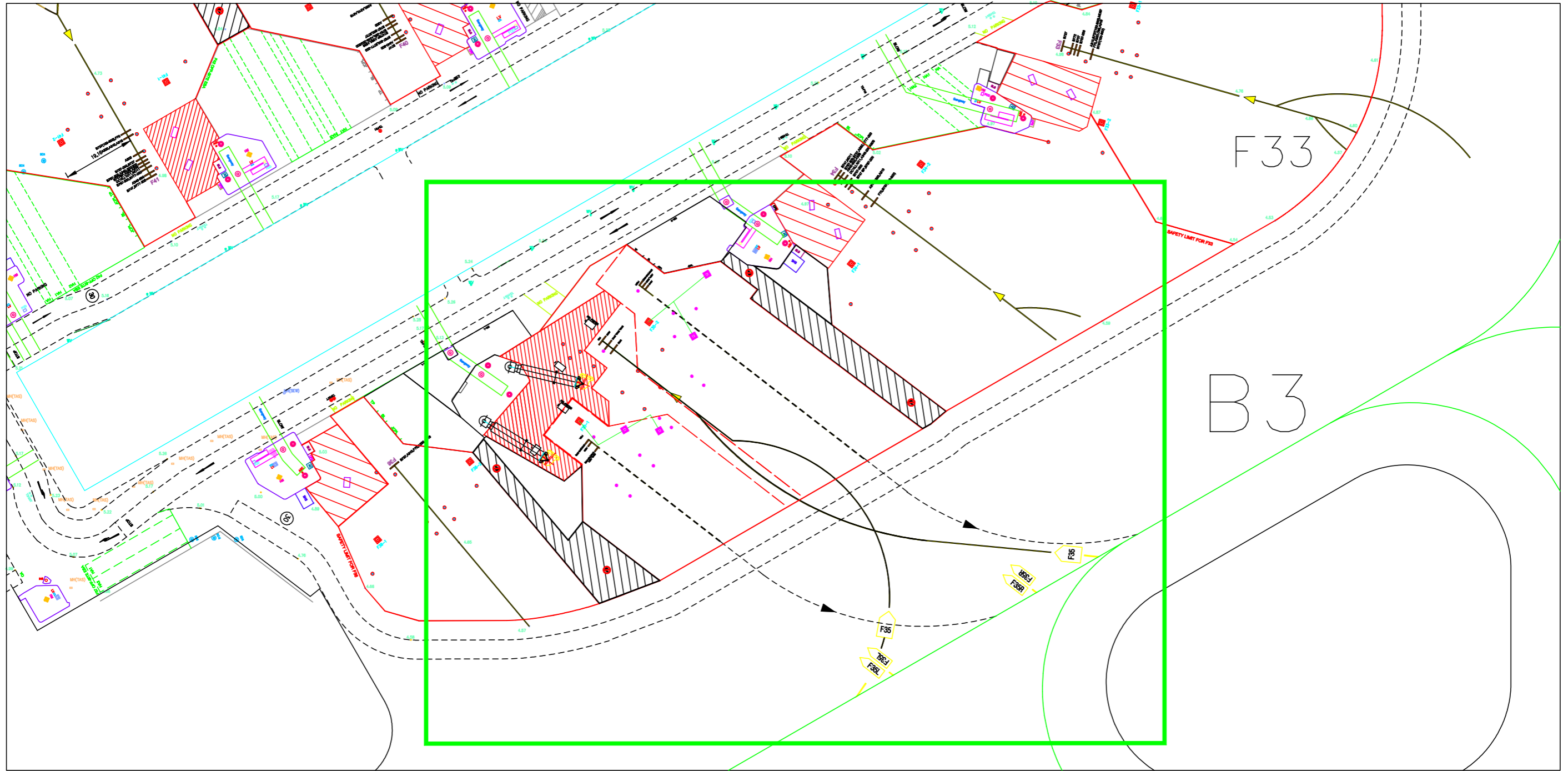

F35, F35L & F35R

*PAGE INTENTIONALLY LEFT BLANK*